

# LAPAROSCOPIC TRAINING BOX

## 腹腔镜训练箱

### 尺寸参数 Dimension



安装后尺寸 (5款训练箱尺寸一致)  
Assembled Size(5 type: the same)



未安装折叠尺寸 (5款训练箱尺寸一致)  
Unassembled Size(5 type: the same)

### 灯光亮度可调节 Adjustable Light Brightness

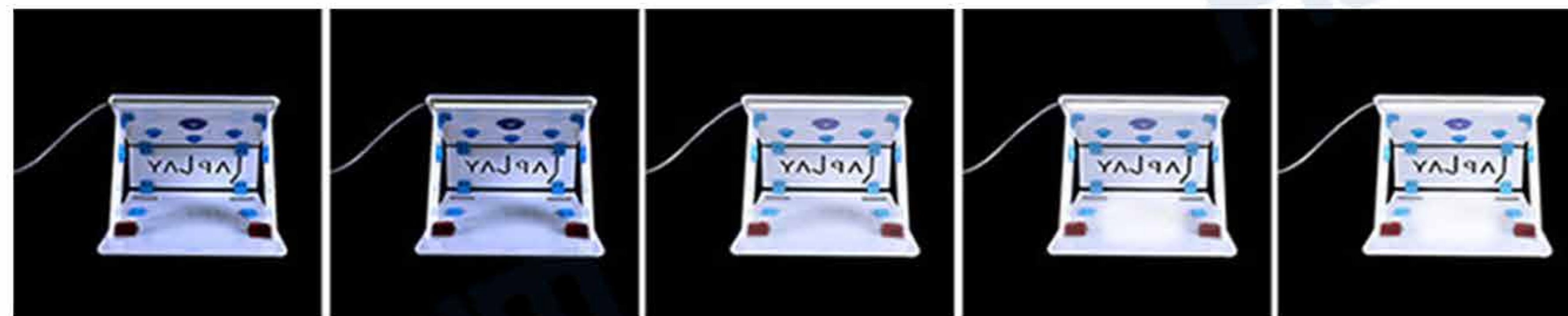

### 安装步骤 Assemble Steps

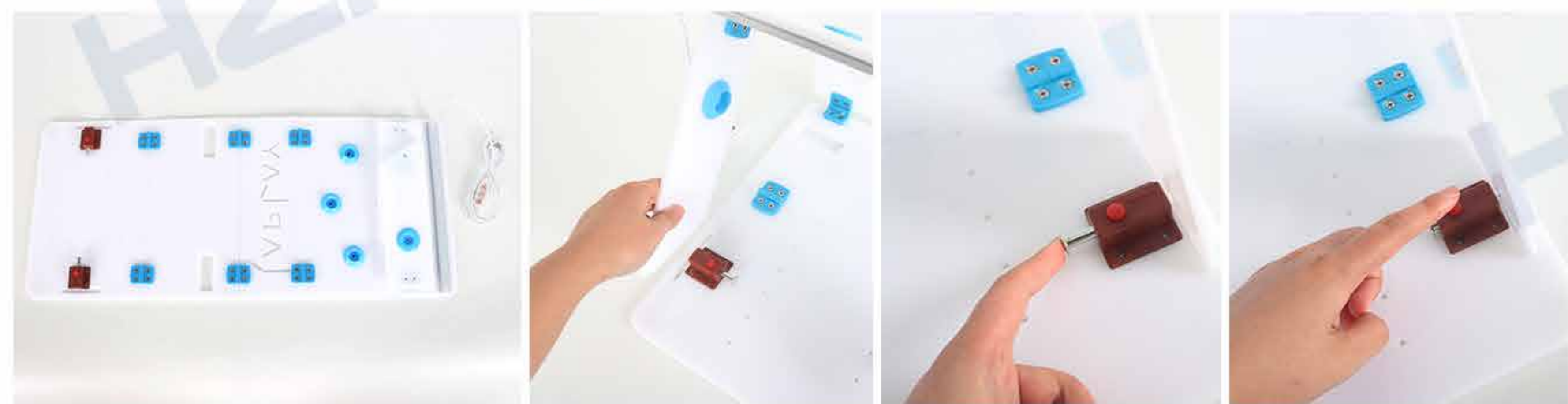

1. 展开放于桌上  
1. Spread it out on the table

2. 把板插进凹槽  
2. Insert the board into the groove

3. 螺丝往里推固定  
3. Push the screw in to fix it

4. 按下按钮弹出螺丝解除固定, 可收回去  
4. Press the button to eject the screw and remove it

### 21训练箱 21-Type Trainer Box

万向节  
摄像头角度可灵活转动  
Cardan Joint  
Camera is 360 degree adjustable.



平板 Tablet

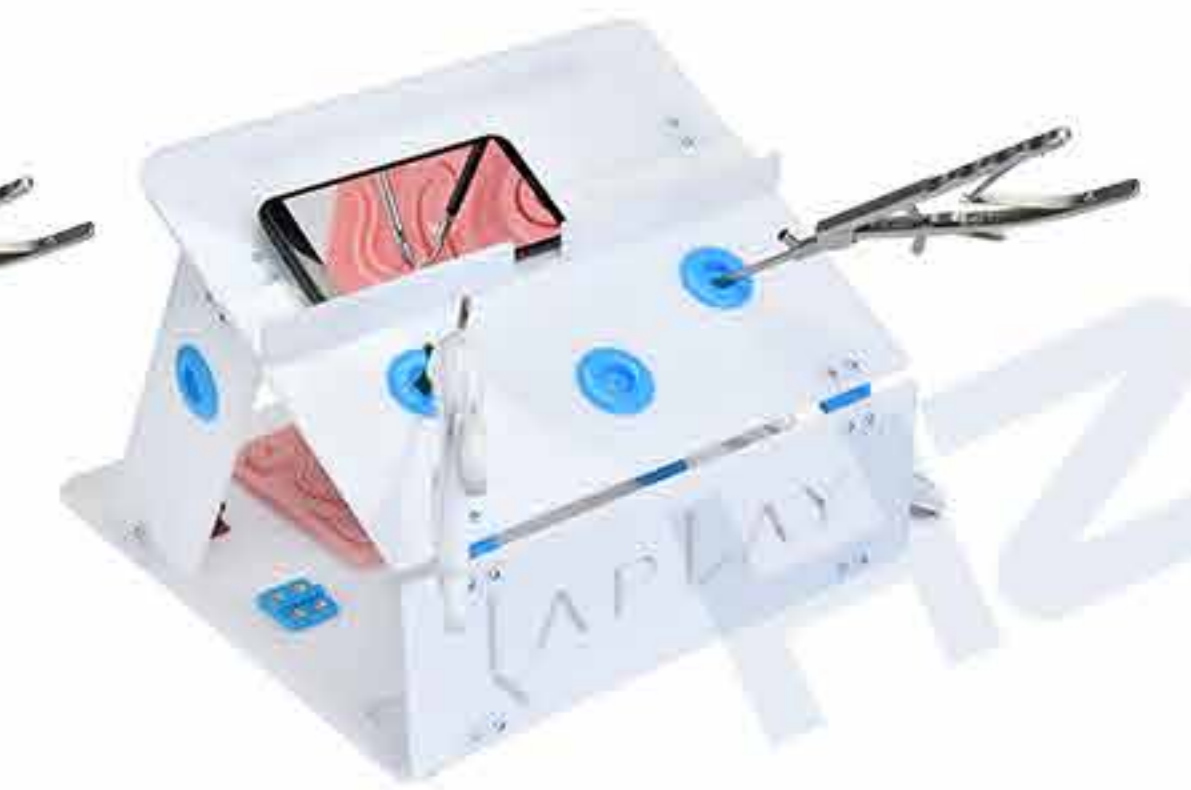

手机 Mobile Phone



内窥镜  
0度和30度直杆 (带光和不带光都可)  
Endoscope  
0° or 30° Straight Rod Endoscope (with or without optica)

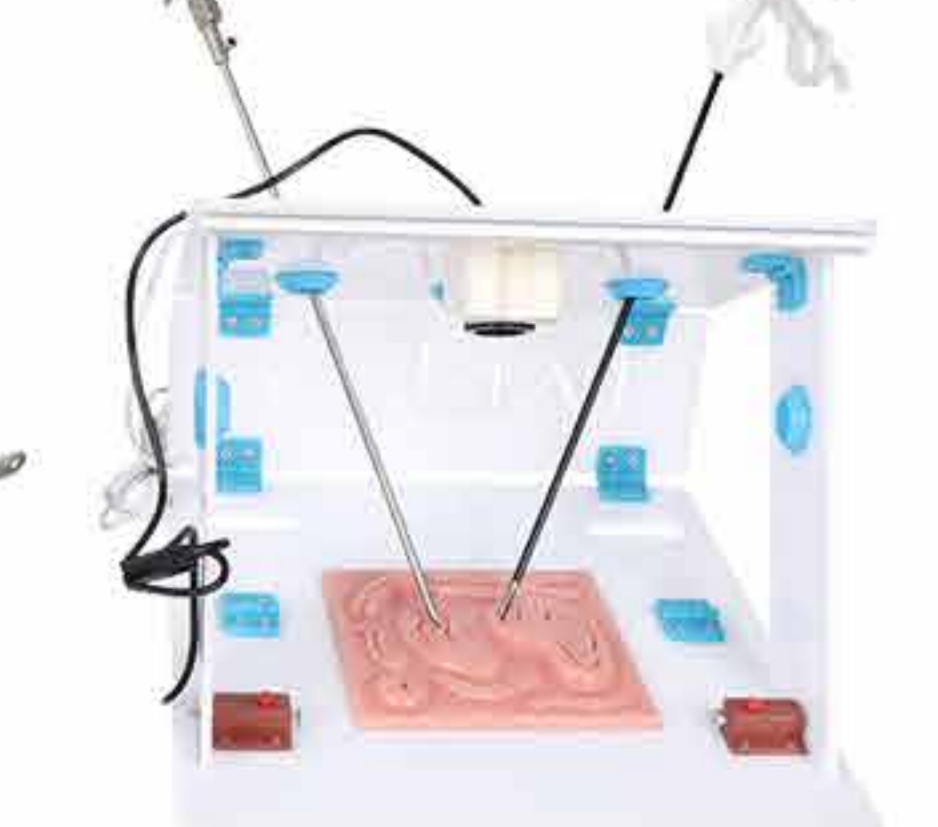

白色摄像头  
White Camera

摄像头: 平板、手机、内窥镜或外接白色摄像头  
Camera: endoscope, tablet, mobile phone or exter white camera

### 单孔训练箱 Single Port Trainer Box

放置单孔器械 器械互不干扰  
Place single port instruments. Instruments do not interfere with each other.



摄像头: 0度和30度直杆内窥镜 (带光和不带光都可)  
Camera: 0° or 30° Straight Rod Endoscope (with or without optica)



0度直杆  
0° straight rod endoscope



30度直杆  
30° straight rod endoscope



0度直杆带光源  
0° straight rod endoscope with optica



30度直杆带光源  
30° straight rod endoscope with optica

# LAPAROSCOPIC TRAINING BOX

## 腹腔镜训练箱

### 21单孔训练箱

#### 21-type Single Port Trainer Box

手机/平板支架  
Mobile phone/tablet holder



摄像头: 手机、平板、0度和30度直杆  
(带光和不带光都可以)

Camera: mobile phone, tablet, 0 degree and 30 degree straight rod endoscope (with or without optica)

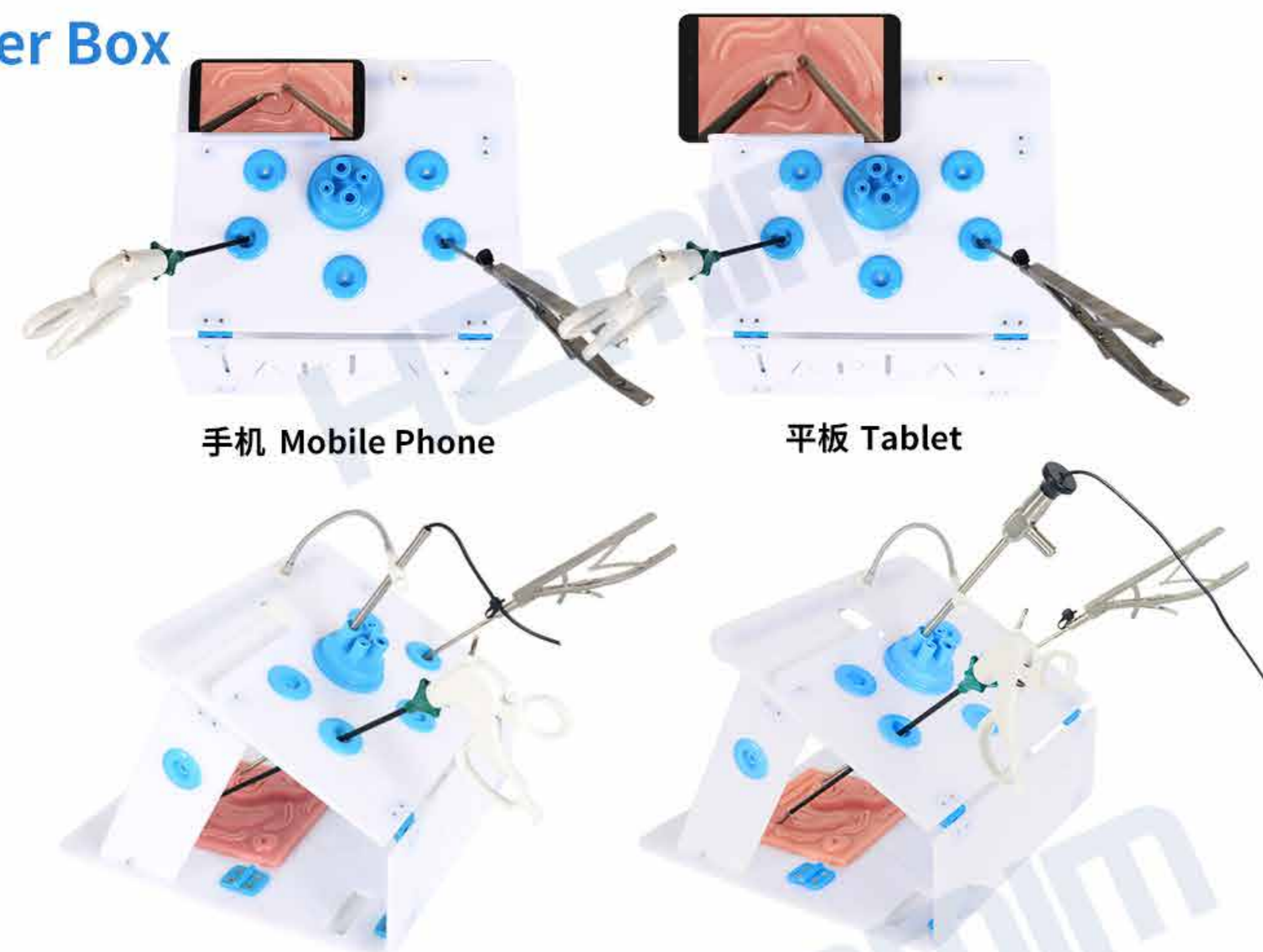

手机 Mobile Phone

平板 Tablet

直杆内窥镜  
Straight Rod Endoscope

直杆内窥镜带光源  
Straight Rod Endoscope with Optica

### 半球型训练箱 Hemispheric Trainer Box



摄像头: 0度和30度直杆内窥镜  
(带光和不带光都可以)

Camera: 0° or 30° Straight Rod Endoscope (with or without optica)

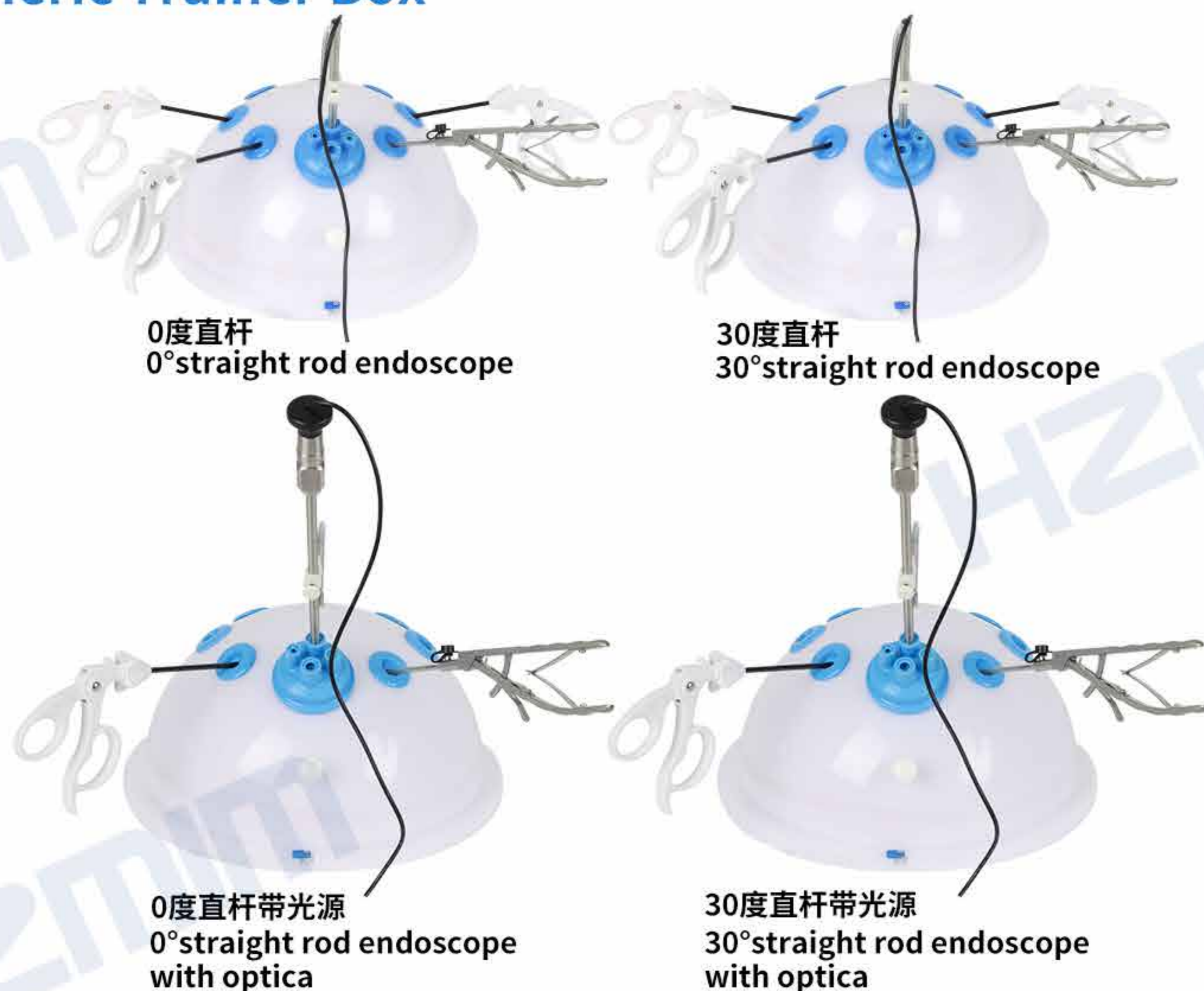

0度直杆  
0° straight rod endoscope

30度直杆  
30° straight rod endoscope

0度直杆带光源  
0° straight rod endoscope with optica

30度直杆带光源  
30° straight rod endoscope with optica

### VGA训练箱 VGA Trainer Box



电脑  
Computer

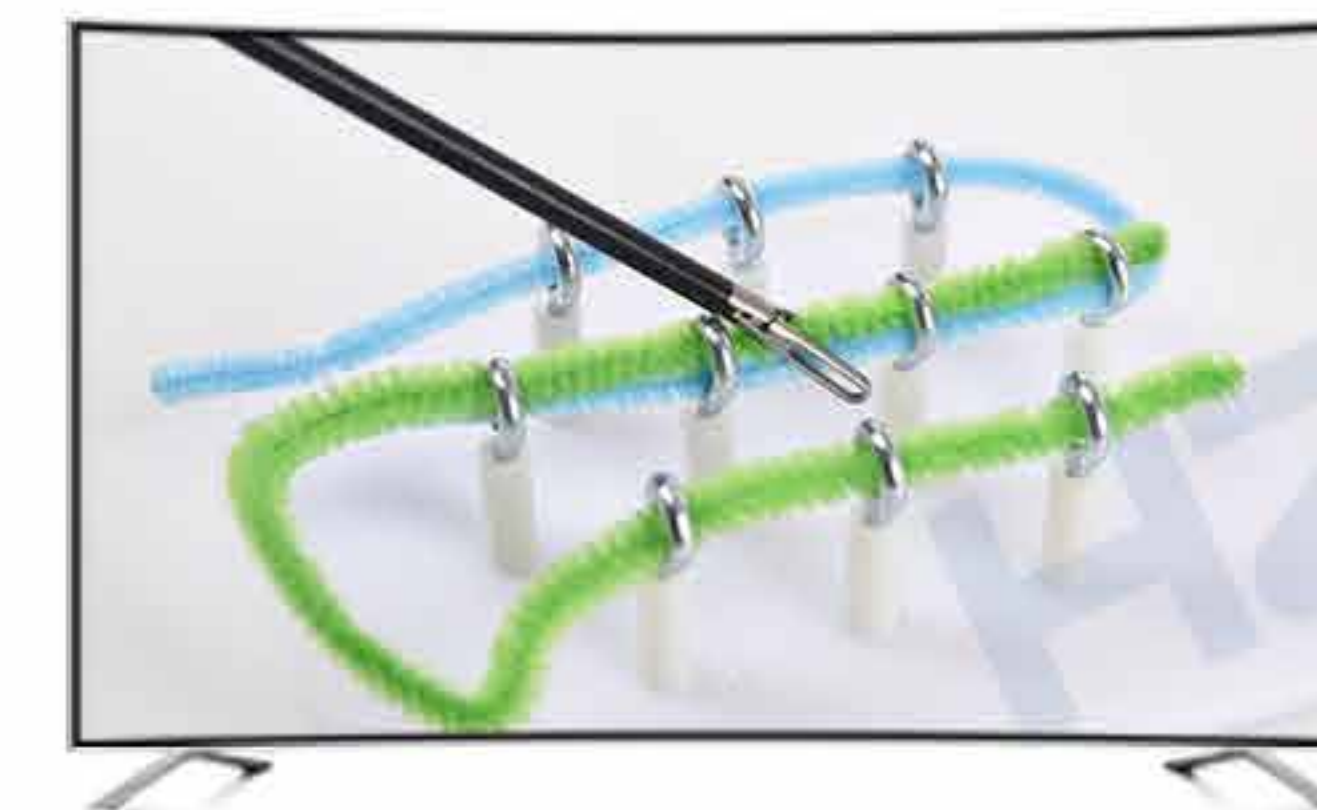

部分液晶电视  
Part of LCD TV

摄像头: VGA摄像头  
(可连电脑、显示器、部分液晶电视)

Camera: VGA Camera  
(can connect with computer, display screen, ans part of LCD TV)



显示器  
Displayer

### 升级版VGA训练箱 Upgraded VGA training box



电脑  
Computer

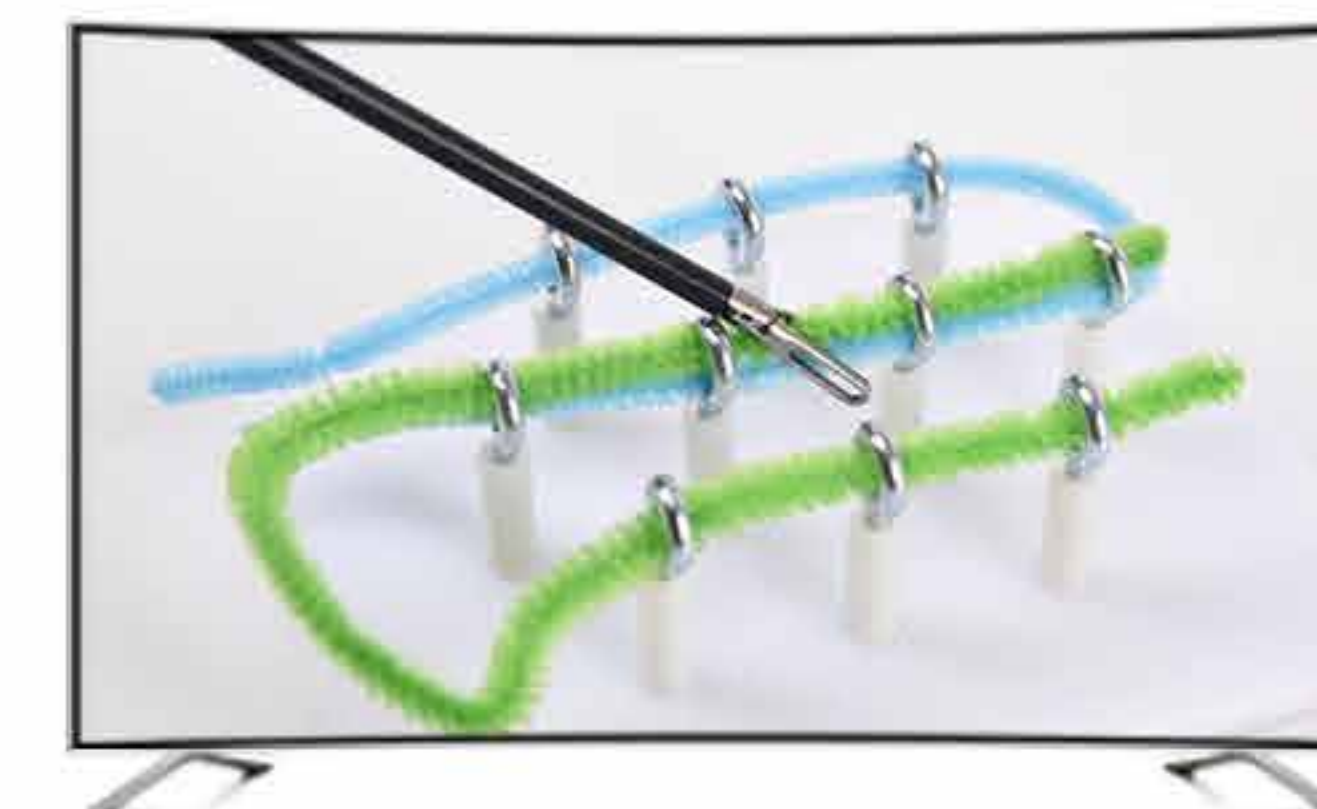

部分液晶电视  
Part of LCD TV

摄像头: VGA摄像头  
(可连电脑、显示器、部分液晶电视)

Camera: VGA Camera  
(can connect with computer, display screen, ans part of LCD TV)



显示器  
Displayer

# LAPAROSCOPIC TRAINING BOX

## 腹腔镜训练箱

### 腹腔仿真式训练箱 Advanced Abdominal Simulation Trainer Box

摄像头: 0度和30度直杆内窥镜 (带光和不带光都可以) Camera: 0° or 30° Straight Rod Endoscope (with or without optica)



颜色1: 白色  
Selection 1: White



颜色2: 肉色  
Selection 2: Incarnadine

1: 1成人比例 腹部隆起 柔软有弹性 模拟气腹状态  
1:1 adult ratio, abdominal heave, soft and elastic, simulating pneumoperitoneum state



柔软 弹性 富有波动感  
真实手术状态的逼真体验  
告别塑料箱体硬邦邦的穿刺孔  
Soft and elastic with a sense of fluctuation, the realistic experience of the real operation state, say goodbye to the rigid puncture hole of the plastic box

### 腹腔仿真式单孔训练箱 Abdominal Single-port Trainer Box

摄像头: 0度和30度直杆内窥镜 (带光和不带光都可以) Camera: 0° or 30° Straight Rod Endoscope (with or without optica)

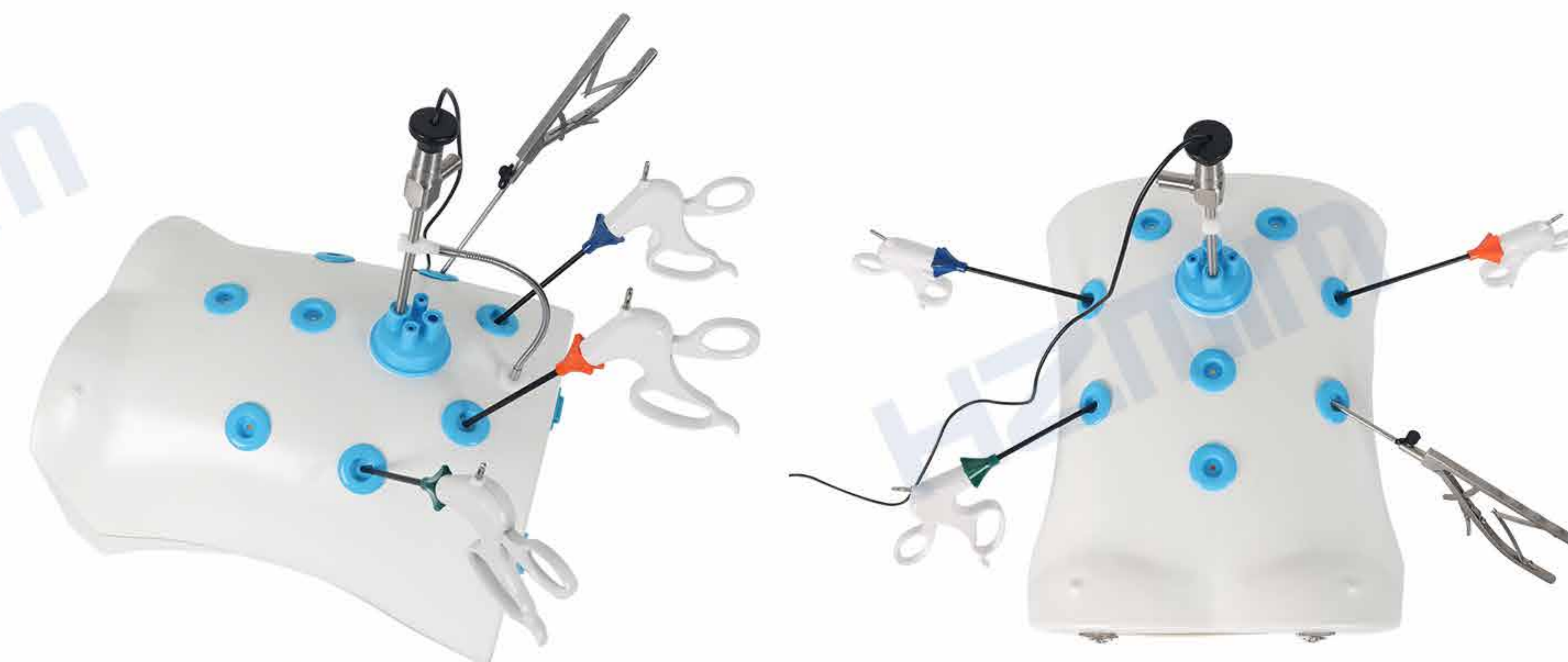

# TROCAR AND 10 MODULES

## 穿刺器和10模块

### 穿刺器 Trocar



尺寸: 5MM、10MM两种规格  
 材料: 医用塑料  
 内容: 一套包含套管和穿刺锥

Dimension: 5mm、10mm  
 Material: Medical-use plastic  
 Contents: A set containing cannula and puncture cone

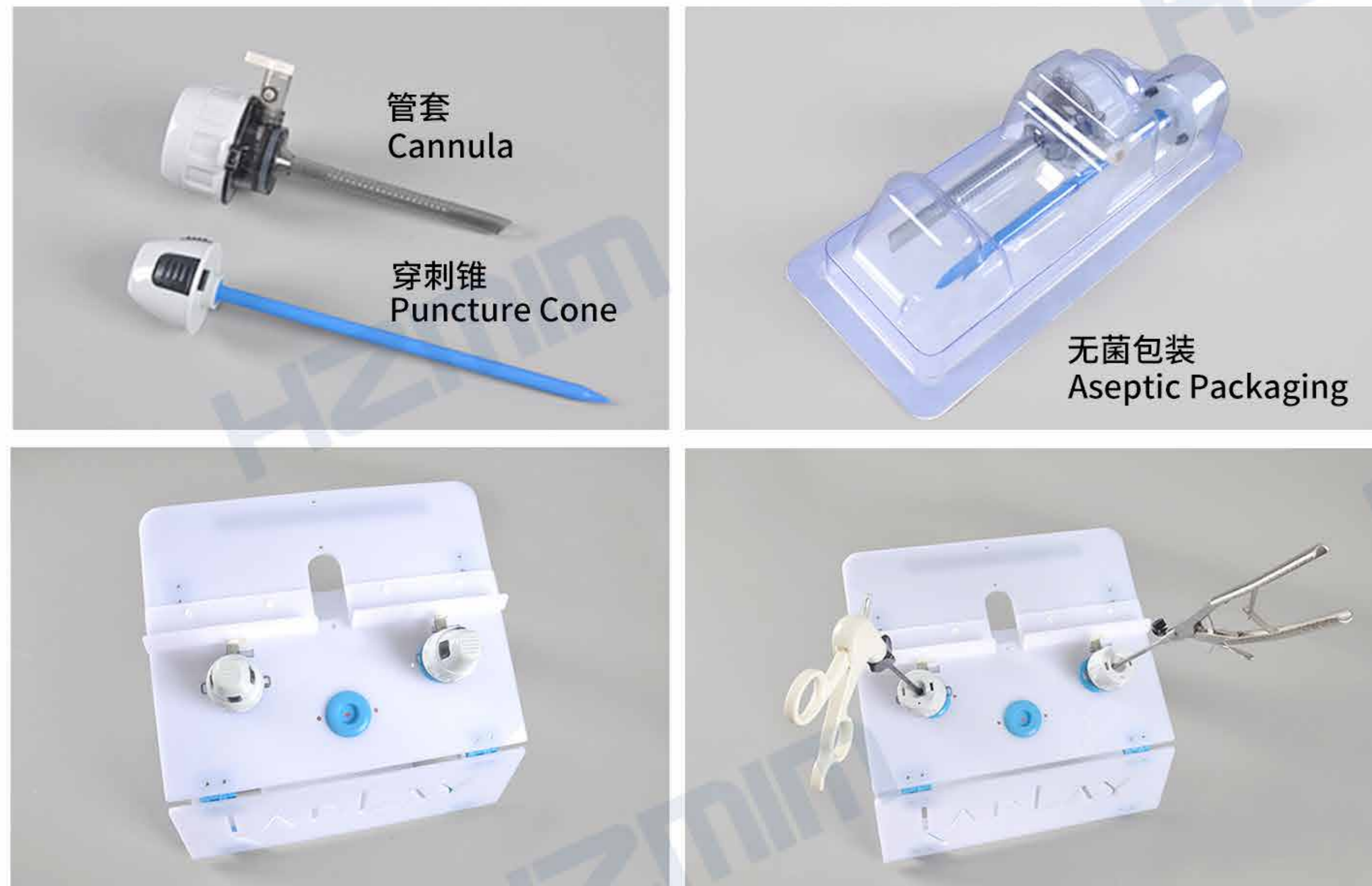

## 10模块 10 Modules

### 3D缝合模块

3D立体仿真结构, 手感真实柔软, 模拟组织各种切口, 满足医学生多种需求

### 3D Suture Module

3D simulation structure, feel real soft, simulate a variety of incision tissue, to meet the various training needs of medical students



### 剥离模块

模拟腹腔内部异常凸起, 食品级硅胶安全无异味, 模拟效果真实

### Stripping Module

Abnormal protrusion in the abdominal cavity is simulated. Food grade silicone is safe without peculiar smell and the simulation effect is real



### 定点皮肤模块

表层有定点, 有益于精准定位, 定点样式多样, 满足多种训练需求, 手感逼真

### Positioning Skin Module

There are fixed points on the surface, which is beneficial to accurate positioning. The fixed points have various styles to meet various training needs and feel realistic

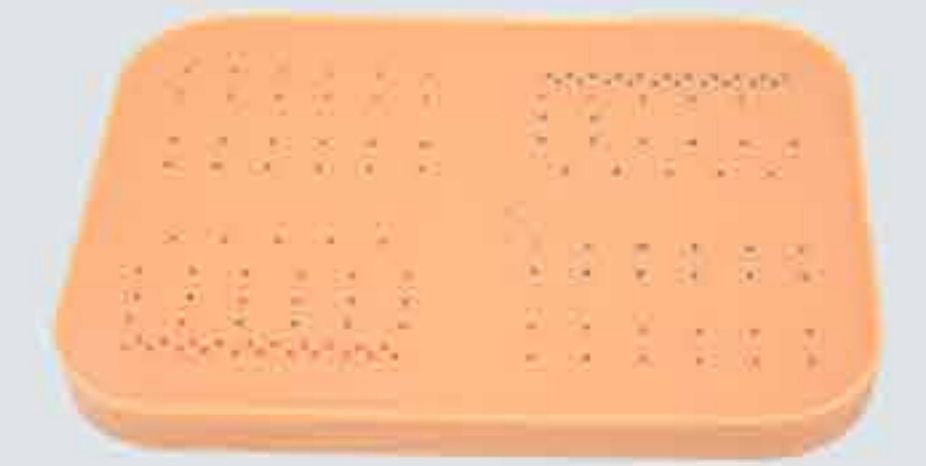

### 夹取模块

主要训练手术中对于细碎物的夹取, 训练操作者夹取精准度和协调度

### Clip Module

It mainly trains the clipping of fine objects in the operation, and trains the accuracy and coordination of the operator



### 穿孔模块

穿孔模块针对训练协调能力培养训练操作者双手精准度

### Perforation Module

Perforation module for training coordination. Cultivate and train the accuracy of operator's hand

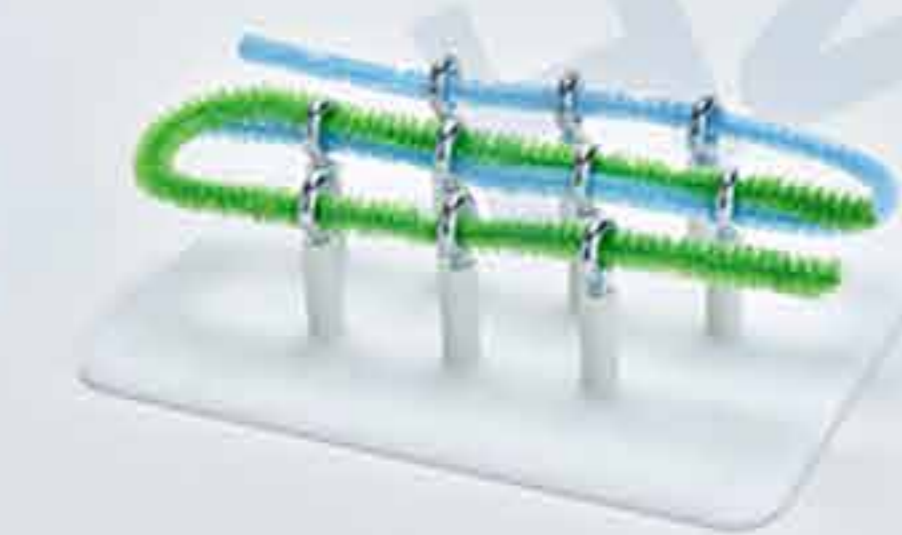

### 牵引模块

对细小有弹性的产品进行夹持操作, 培养操作者清晰的手感反馈和精准的力度调节

### Traction Module

The clamping operation of small elastic products can cultivate clear hand feel feedback and precise force adjustment



### 夹珠/夹球模块

训练手腕腕力灵活及精准度, 让操作者更加从容应对手术中的细节

### Clamping module

The training of wrist flexibility and precision allows the operator to handle the details of surgery more easily.



### 套扎模块

模拟人体器官模块进行组织套扎和切除的训练

### Banding Training Module

Simulate organ modules in the human abdominal cavity for training of tissue ligation and resection.



### 剪切模块

培养精准度, 引进美国FLS概念, 设计符合国内腹腔镜训练的剪切模块

### Precision Cutting Module

American FLS concept, the design of cutting module in line with the domestic laparoscopic training



# CAMERA LENS 镜头

## 直杆内窥镜 Straight Rod Endoscope

- 1080P 60帧/秒
- USB接口
- 手动调焦 任意角度调节
- WINDOWS MAC IOS 全系列支持  
(手工测量, 可能有少许误差)

- 1080P 60FPS
- USB interface
- Manually adjustable focus, arbitrary angle adjustment
- Support Windows/Mac/Os system  
(Manually measure, not accurate)

### 30度直杆和手术一致 训练更真实

30 degree straight rod endoscope is consistent with surgery (more realistic)

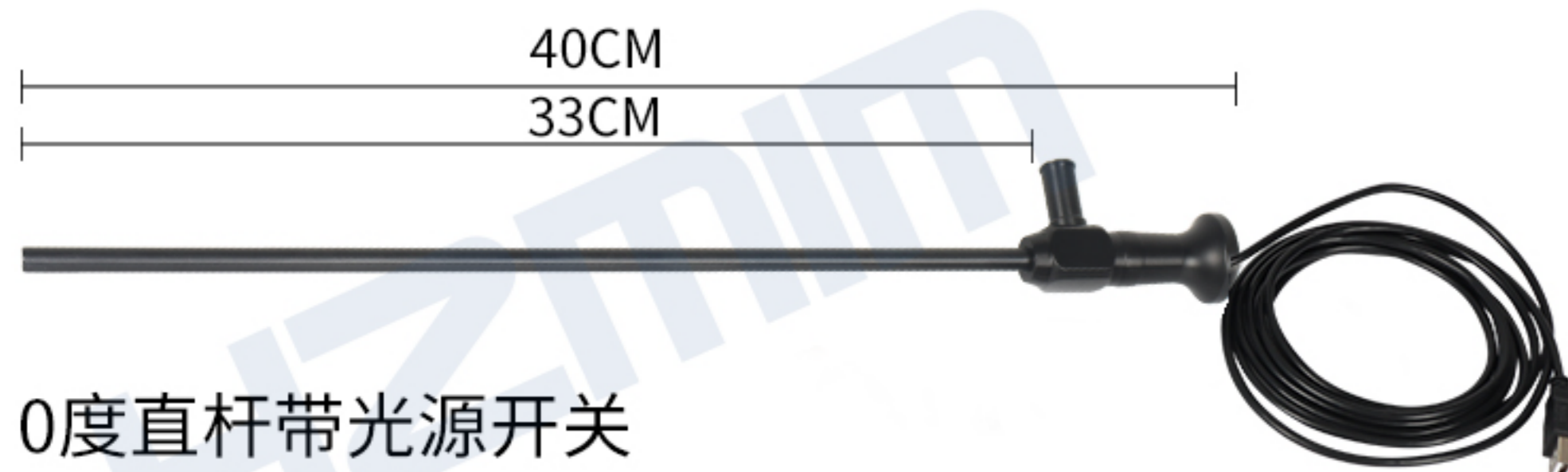
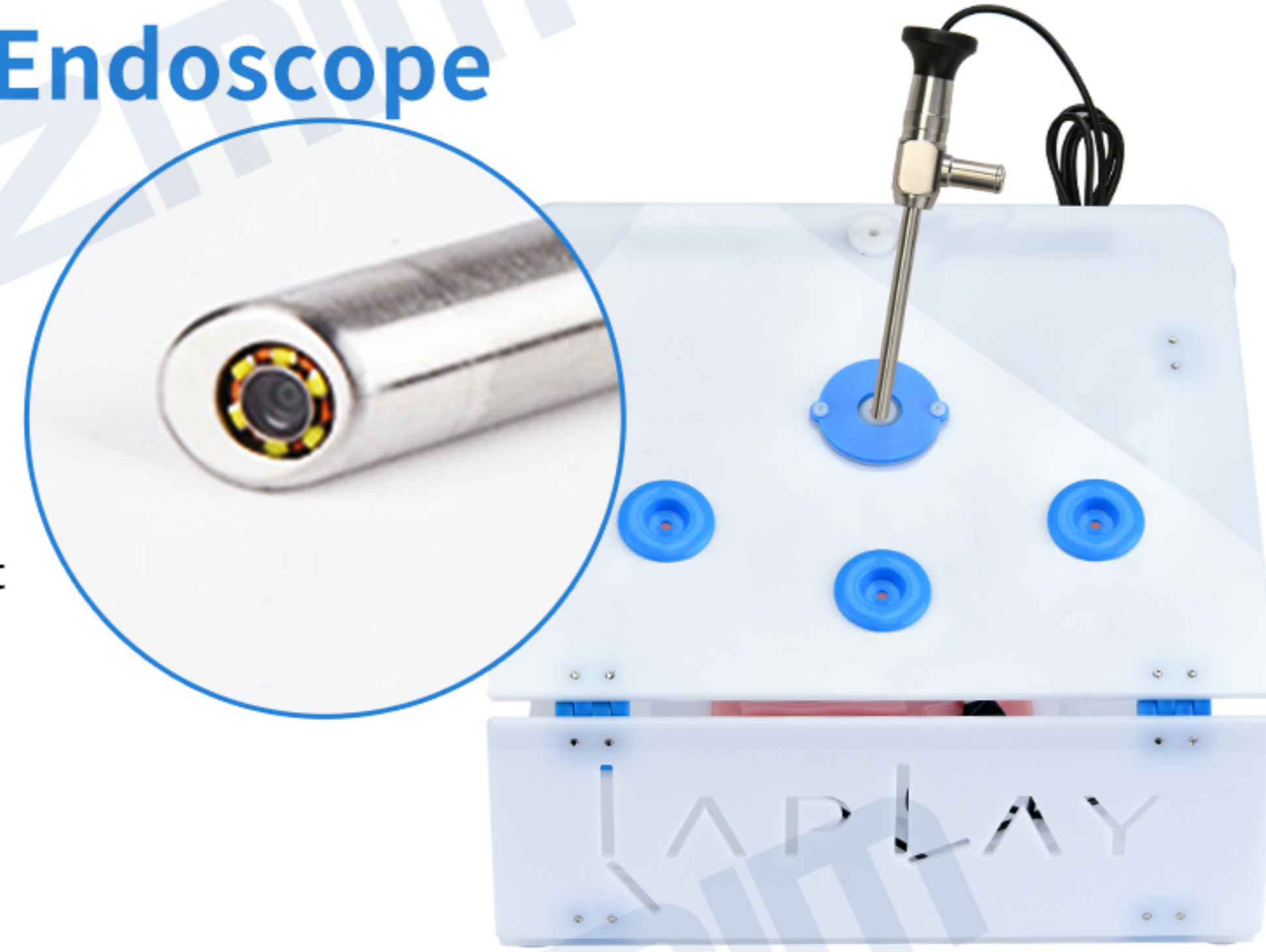

0度直杆带光源开关  
铝合金材料 阳极氧化黑色外表  
0°straight rod endoscope with optica  
Aluminum alloy material, anodized black appearance

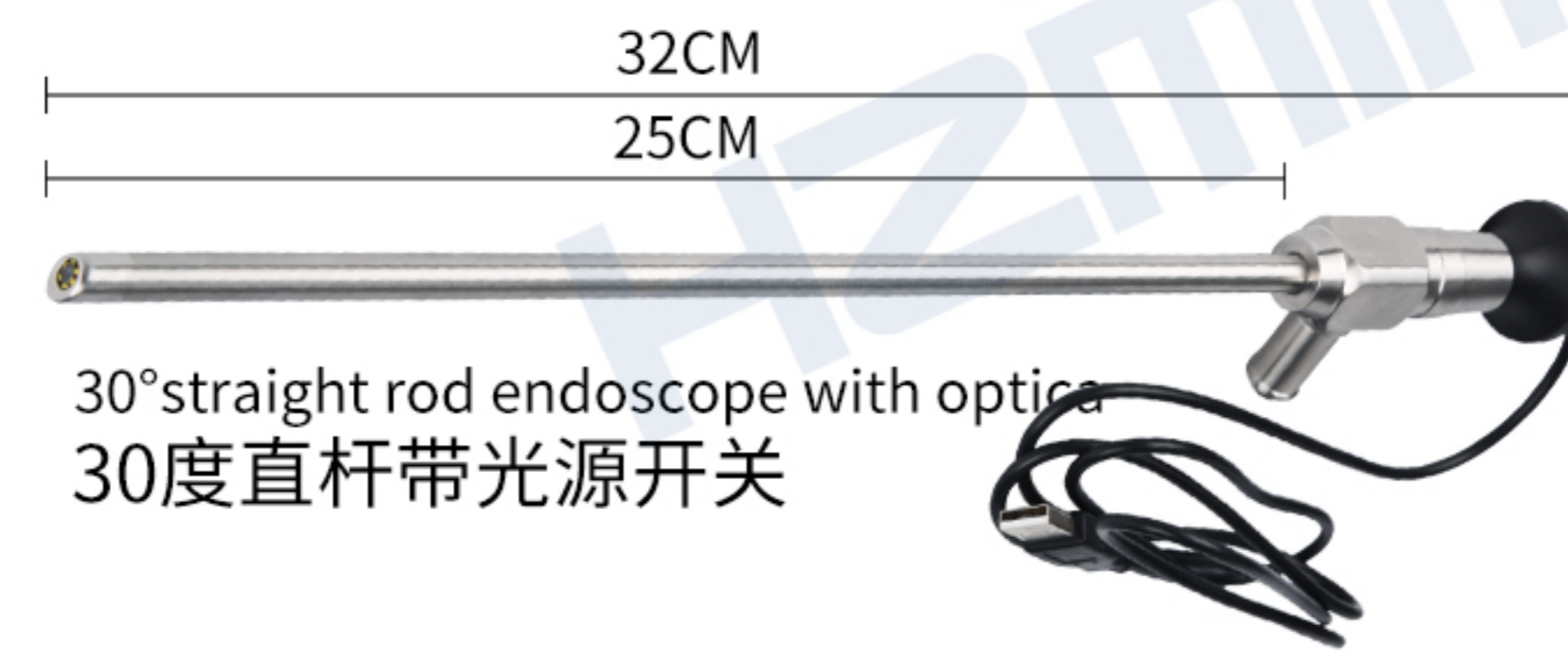
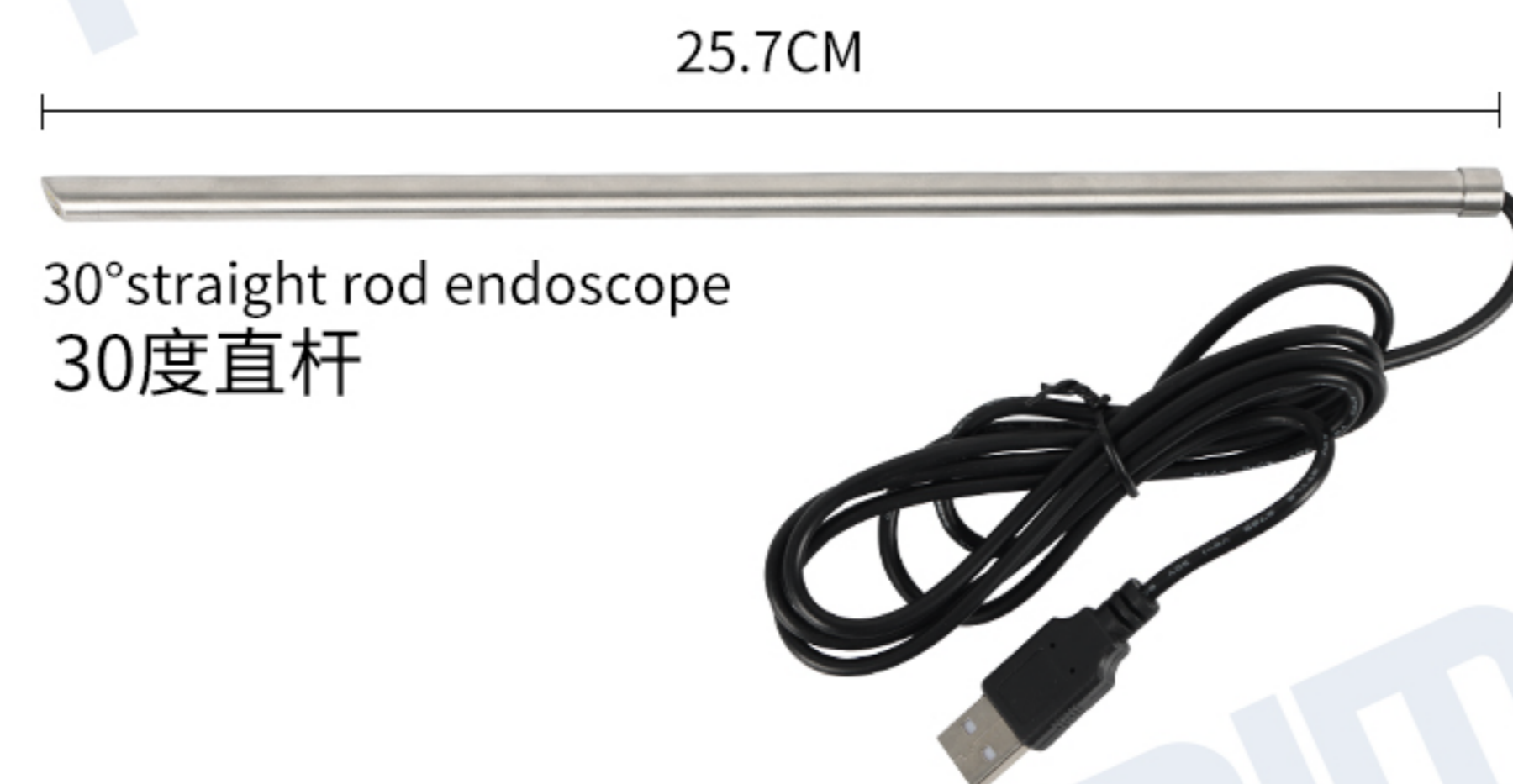

30度直杆带光源开关  
铝合金材料 阳极氧化黑色外表  
30°straight rod endoscope with optica  
Aluminum alloy material, anodized black appearance

## 白色高清摄像头 White HD Camera

- 1920X1080P 30帧/秒
- 带光源12颗LED灯
- USB接口 手动调焦 任意角度调节
- WINDOWS(配软件) MAC(QUICK CAMERA) IOS 全系列支持
- 快速准确对焦, 图像明亮高对比度
- 1920×1080P 30FPS
- With 120 LED lights
- USB interface, manually adjustable focus, arbitrary angle adjustment
- Windows(with software) MAC(QUICK CAMERA) Support IOS full series
- Fast and accurate focus, bright image with high contrast



## 黑色高清摄像头 Black HD Camera

- 1080P
- 高清画质, 呈现真实手术视野
- 手动对焦
- WINDOWS、苹果系统都可以使用
- 苹果系统支持第三方驱动
- 1080P
- High-defination picture quality, showing the real surgical field
- Manual focus
- Support windows/Apple system
- Apple system support third-party drivers



## VGA高清摄像头 VGA HD Camera

- VGA USB 1080P BNC130W 45帧/秒
- 无需驱动 图像清晰
- 直接连接显示器 三合一接口
- 相机规格: 75x65x55mm
- 信号: BNC/AV VGA USB
- VGA USB 1080P BNC130W 45FPS
- No drive, clear image
- Directly connect to monitor. Three in one interface.
- Camera Dimension: 75×65×55mm
- Signal: BNC/AV VGA USB



## 应用场景 Application



# LAPAROSCOPIC TRAINING INSTRUMENT

## 腹腔镜训练器械

### 持针钳 (V型/弯头) Needle Holder(V shape/angle head)

- 产品名称: 持针钳 产品净重: 230g
- 产品材质: 医用级不锈钢 产品尺寸: 330mm\*5mm
- 特点: 临床医用器械级别材质, 手感更真实, 更耐用
- Product Name: Needle Holder Net Weight: 230g
- Material: Medical grade stainless steel Dimension: 330mm\*5mm
- Feature: Clinical medical grade instrument material, more real, more durable

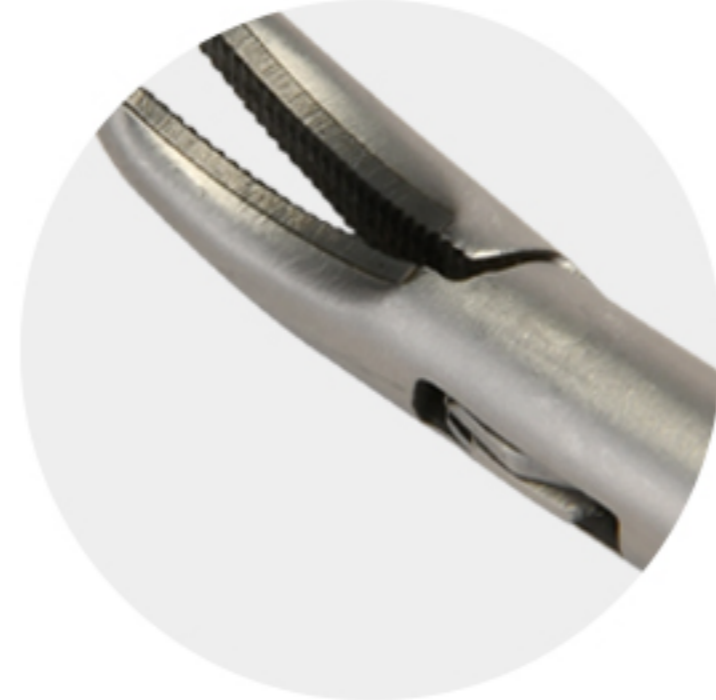
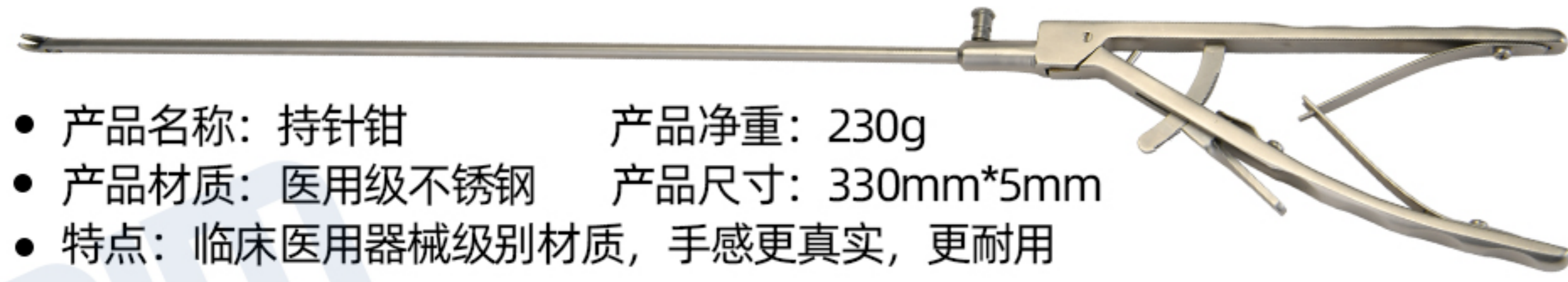

头部为高耐磨钨钢 齿位流畅清晰  
Made of high wear resistant tungsten steel With smooth and clear teeth

### 分离钳 (弯头/360度旋转转盘) Dissecting Forceps(Angle head/360 degree rotatable)

- 产品名称: 分离钳 产品净重: 90g
- 产品材质: 医用级不锈钢 产品尺寸: 330mm\*5mm
- 特点: 进口材料打造, 轻巧不累, 长久使用不变形
- Product Name: Dissecting Forceps Net Weight: 90g
- Material: Medical grade Stainless Steel Dimension: 330mm\*5mm
- Feature: Made of imported material. Light and not tired, use for a long time without deformation



缝合搭配 操作灵敏  
解剖剪切  
Suture collocation, flexible operation, anatomic shear

### 孔槽抓钳 (直头/360度旋转转盘) Fenestrated Grasper(Straight head/360 degree rotatable)

- 产品名称: 孔槽抓钳 产品净重: 90g
- 产品材质: 医用级不锈钢 产品尺寸: 330mm\*5mm
- 特点: 操作灵敏, 舒适不易疲劳
- Product Name: Fenestrated Grasper Net Weight: 90g
- Material: Medical grade stainless steel Dimension: 330mm\*5mm
- Feature: Flexible operation, comfortable and not easy to fatigue



抓取训练 协调能力  
提升准确度  
Grasping and coordination ability training, improve accuracy

### 剪刀 (弯头/360度旋转转盘) Scissor(angle head/360 degree rotatable)

- 产品名称: 剪刀 产品净重: 90g
- 产品材质: 医用级不锈钢 产品尺寸: 330mm\*5mm
- 特点: 适用腹腔镜解剖、剪切缝合等操作
- Product Name: Scissor Weight: 90g
- Material: Medical grade stainless steel Dimension: 330mm\*5mm
- Feature: Applicable to laparoscopic anatomy, shear suturing and other operations



弯头刀头 仿真设计  
操作灵敏  
Angle head Simulation design  
Flexible operation

### 单孔腹腔镜 训练专用器械 Special Instruments for Single-port laparoscopic Trainer Box

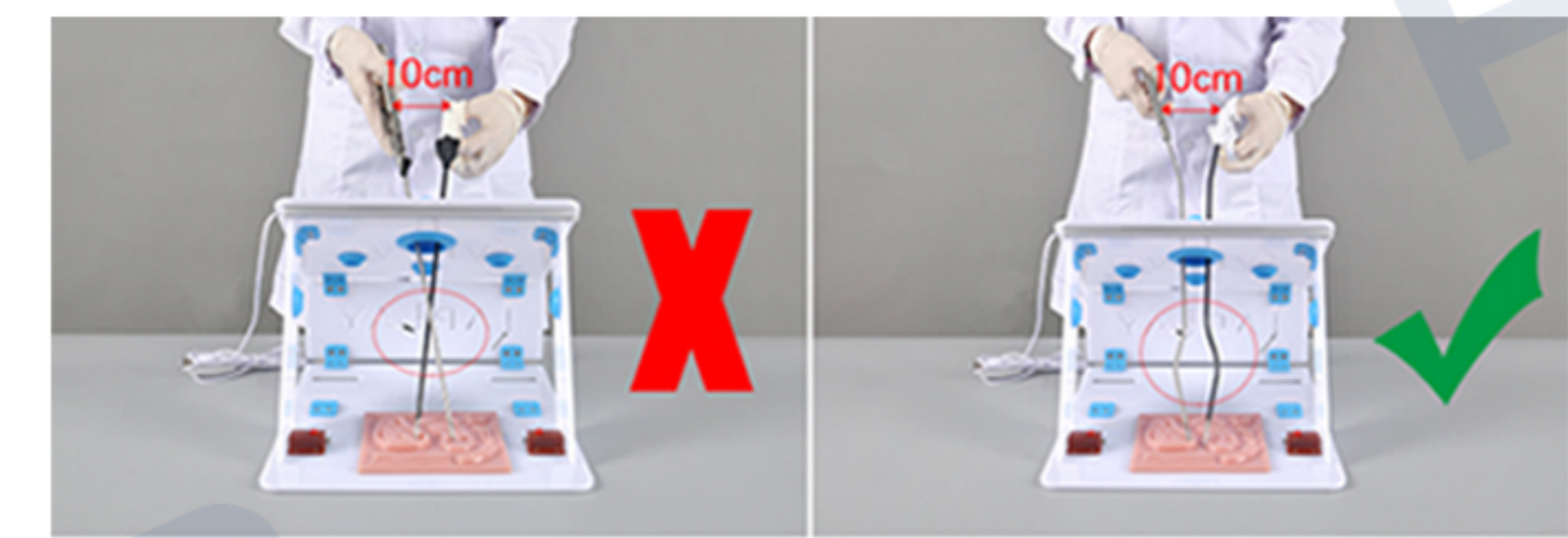

普通器械 使用单孔训练箱  
的操作演示

General Instruments:  
operation demonstration  
for single port trainer box

单孔器械 使用单孔训练箱  
的操作演示

Single-port Instruments:  
operation demonstration for  
single-port trainer box

### 持针钳 (V型/弯头) Needle Holder(V shape/angle head)

- 产品名称: 持针钳 产品净重: 230g
- 产品材质: 医用级不锈钢 产品尺寸: 530mm\*5mm
- 特点: 临床医用器械级别材质, 手感更真实, 更耐用
- Product Name: Needle Holder Net Weight: 230g
- Material: Medical grade stainless steel Dimension: 530mm\*5mm
- Feature: Clinical medical grade instrument material, more real, more durable

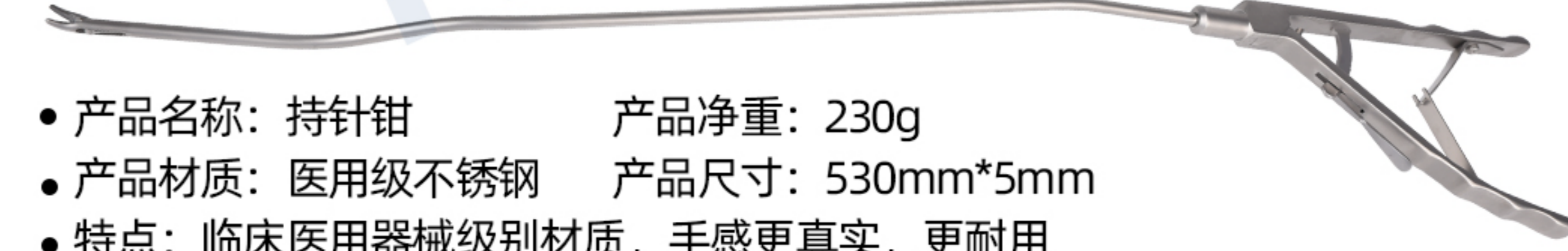

头部为高耐磨钨钢  
齿位流畅清晰  
Made of high wear resistant tungsten steel With smooth and clear teeth

### 分离钳 (弯头/360度旋转转盘) Dissecting Forceps(Angle head/360 degree rotatable)

- 产品名称: 分离钳 产品净重: 100g
- 产品材质: 医用级不锈钢 产品尺寸: 530mm\*5mm
- 特点: 进口材料打造, 轻巧不累, 长久使用不变形
- Product Name: Dissecting Forceps Net Weight: 90g
- Material: Medical grade Stainless Steel Dimension: 330mm\*5mm
- Feature: Made of imported material. Light and not tired, use for a long time without deformation



缝合搭配 操作灵敏  
解剖剪切  
Suture collocation, flexible operation, anatomic shear

### 孔槽抓钳 (直头/360度旋转转盘) Fenestrated Grasper(Straight head/360 degree rotatable)

- 产品名称: 孔槽抓钳 产品净重: 100g
- 产品材质: 医用级不锈钢 产品尺寸: 530mm\*5mm
- 特点: 操作灵敏, 舒适不易疲劳
- Product Name: Fenestrated Grasper Net Weight: 90g
- Material: Medical grade stainless steel Dimension: 330mm\*5mm
- Feature: Flexible operation, comfortable and not easy to fatigue



抓取训练 协调能力  
提升准确度  
Grasping and coordination ability training, improve accuracy

### 剪刀 (弯头/360度旋转转盘) Scissor(angle head/360 degree rotatable)

- 产品名称: 剪刀 产品净重: 100g
- 产品材质: 医用级不锈钢 产品尺寸: 530mm\*5mm
- 特点: 适用腹腔镜解剖、剪切缝合等操作
- Product Name: Scissor Weight: 90g
- Material: Medical grade stainless steel Dimension: 330mm\*5mm
- Feature: Applicable to laparoscopic anatomy, shear suturing and other operations

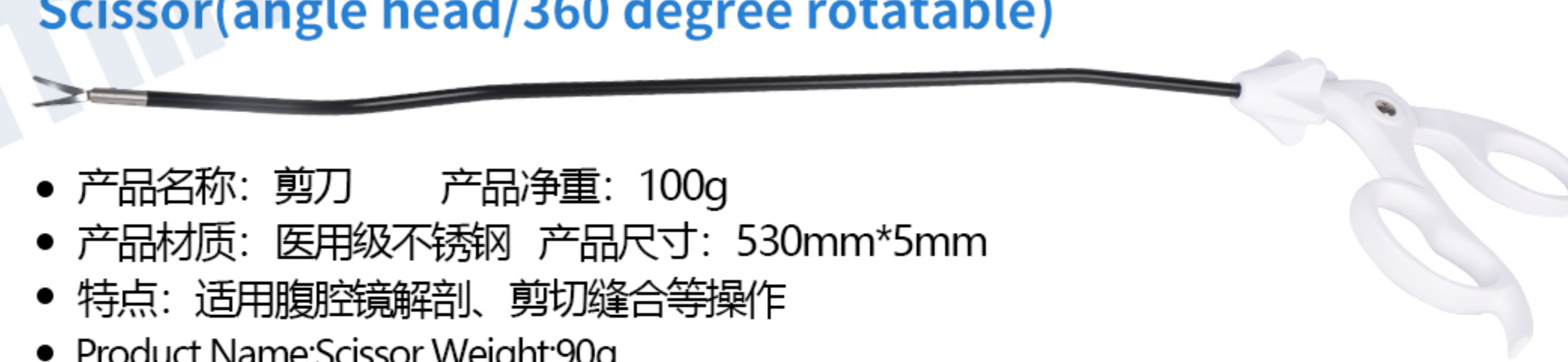

弯头刀头 仿真设计  
操作灵敏  
Angle head Simulation design  
Flexible operation

# AUTOMATIC LIFTING TABLE

## 自动升降桌

### 产品解析 Product Details



显示屏  
Screen

分辨率: 1400x900 屏幕类型: LED  
防蓝光设计 色彩饱和细腻  
Resolution:1400\*900 Screen:LED  
Anti blue light design,saturated and delicate color

支架  
Stand

冷轧钢材质 最大承重10kg 管径28mm  
柱高800mm 高低调节可满足不同身高  
角度调节可满足各种特殊需求  
Cold-rolled steel Maximum Bearing Capacity 10kg  
Pipe Diameter 28mm  
Column Height 800mm  
Height adjustment can meet different height needs.  
Angle adjustment can meet various special needs

VGA镜头  
VGA Camera

图像清晰 三合一接口  
(可连电脑、显示器、部分液晶电视)  
清晰度:VGA USB 1080P  
BNC130W 45帧/秒 相机规格:75x65x55mm  
信号:BNC/AV VGA USB  
Image clear three-in-one interface  
(can connect computer, monitor, part of LCD TV)  
definition: VGA USB 1080P  
BNC130W 45 frames/second  
Camera Specification: 75x65x55mm  
Signal: BNC/AV VGA USB

训练箱  
Trainer Box

折叠后28x38cm 小巧便捷 与15寸笔记本电脑差不多  
一键式拆装设计 反复使用  
After folding, 28x38cm is compact and convenient,  
which is similar to the one-button disassembly and  
assembly design of 15-inch laptop

自动升降桌  
Automatic Lift Table

桌面尺寸60x50cm 净重25kg 桌面升降高度63-80cm  
输入电压220V/50HZ 最大载重55kg  
Table Size:60x50cm Net Weight:25kg  
Table Lifting Height:63-80cm  
Input Voltage: 220V/50HZ Maximum Load: 55kg

电源口  
Power Port

提供电源接口 无需插电板  
Provide power port  
Don't need socket

万向轮  
Universal Wheel

带刹车设计 安全可靠 静音顺滑 灵活快速  
With brake design, safe and reliable  
Quiet, smooth, flexible and fast moving



- 1 USB接口 (连接电脑)  
USB interface  
(connect with computer)
- 2 BNC/AV接口  
(连接液晶电视)  
BNC/AV interface  
(connect with LCD TV)
- 3 功能按键  
Function Button
- 4 VGA接口 (连接显示器)  
VGA interface  
(connect with displayer)
- 5 电源口  
Power Port



### 产品安装 Assemble Way



十字小螺丝和垫片  
(显示器)  
Small cross Screw and gasket  
(displayer)



垫片和螺帽  
(支架)  
Gasket and nut  
(stand)



十字短螺丝(升降柱 桌底)  
Cross short screw  
(lifting column under the table)

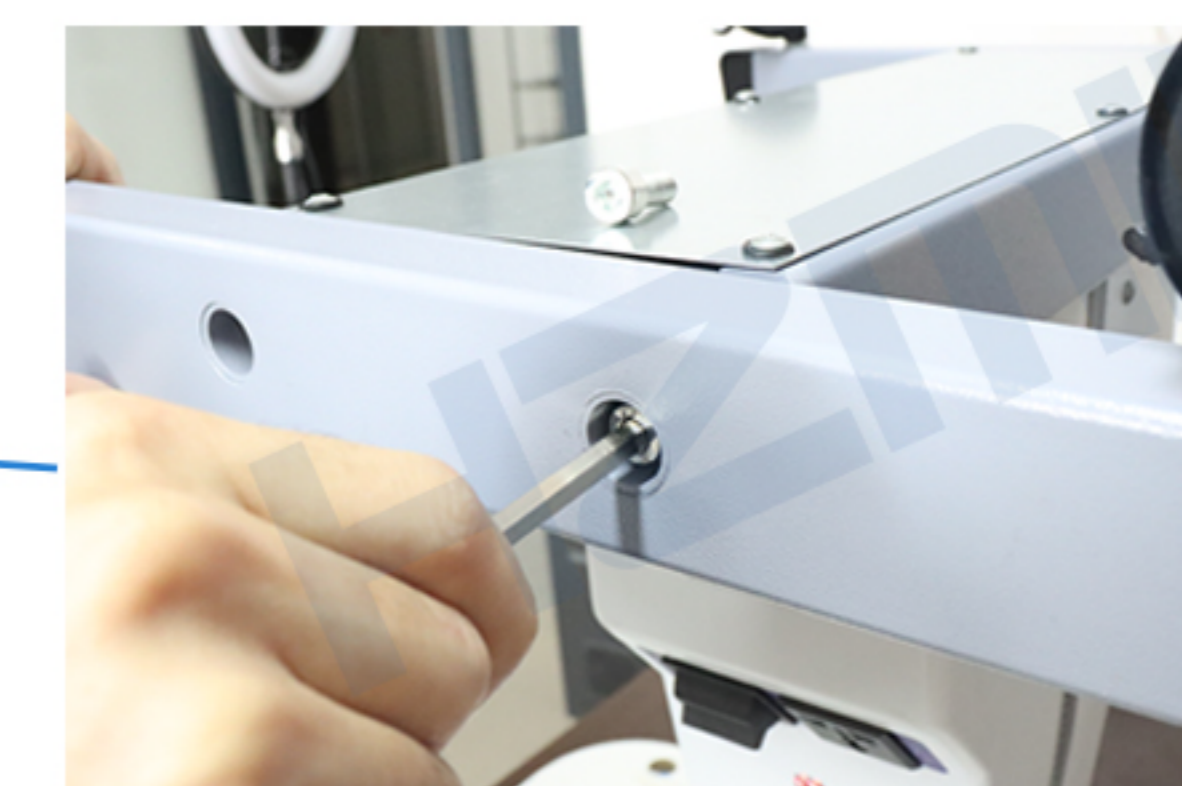

内六角螺丝(底部桌脚)  
Inner six hexangular screw  
(At the bottom of the table corner)

### 产品安装小配件 Product Installation Gadgets

